

NEWASIA
ASIAJOINT

Grooved Pipe Fittings

Ductile Catalog



NEWASIA
ASIAJOINT

<http://www.ajs.co.kr>

Ductile Grooved fittings

● Ductile Grooved Elbow

90/45D Grooved Outlet : XGQT01/XGQT02

- Mat'l : Ductile iron(GCD450)

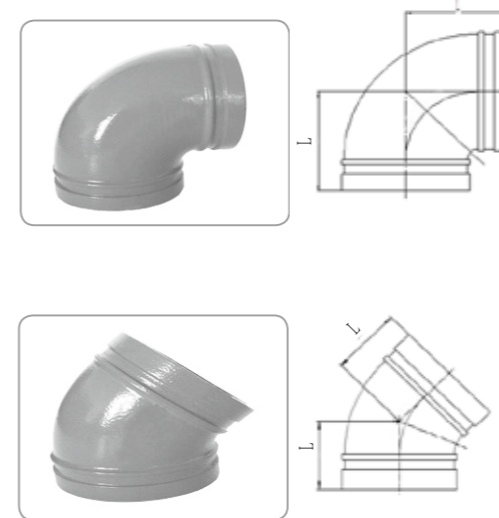

Nominal Size DN inch	Pipe O,D (mm)	Max. Working Pressure (kgf/cm2)	Dimensions (mm) / Length(L)	
			90°	45°
			XGQT01	XGQT02
25 1	33.7	21	57	
32 1.1/4	42.4	21	60	
40 1.1/2	48.3	21	60	
50 2	60.3	21	70	51
65	76.1	21	76	57
2.1/2	73.0	21	76	57
80 3	88.9	21	86	64
100 4	114.3	21	102	76
125	139.7	21	122	83
5	141.3	21	122	83
150	165.1	21	140	89
6	168.3	21	140	89
200	216.3	21	175	108
8	219.1	21	175	108

22.5/11.25D Grooved Outlet : XGQT09/XGQT9

Nominal Size DN inch	Pipe O,D (mm)	Max. Working Pressure (kgf/cm2)	Dimensions (mm) / Length(L)	
			22.5°	11.25°
			XGQT09	XGQT9
25 1	33.7	21		
32 1.1/4	42.4	21		
40 1.1/2	48.3	21		
50 2	60.3	21	48	35
65	76.1	21	51	38
2.1/2	73.0	21	51	38
80 3	88.9	21	57	38
100 4	114.3	21	73	45
125	139.7	21	73	51
5	141.3	21	73	51
150	165.1	21	79	51
6	168.3	21	79	51
200	216.3	21		
8	219.1	21		

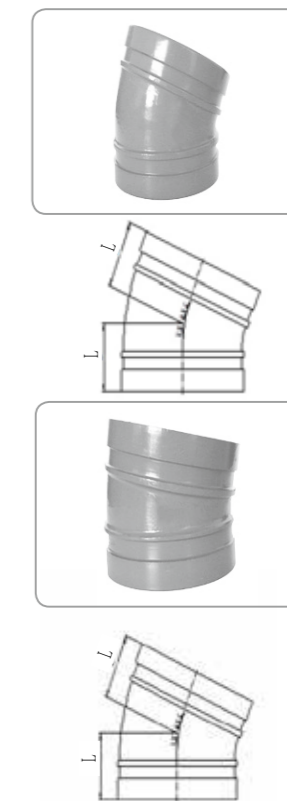

Ductile Grooved Tee

Grooved Equal/Reducing Tee: XGQT03/ XGQT04

Mat'l : Ductile iron(GCD450)

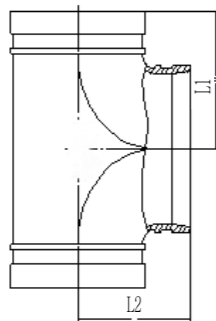

Grooved Equal Tee

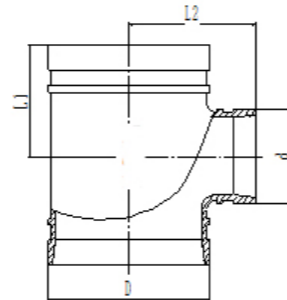

Reducing Tee

Nominal Size (A)	Pipe O.D. (mm)	Max. Working Pressure (kgf/cm ²)	Dimensions(mm)/Length L			Nominal Size (A)	Pipe O.D. (mm)	Max. Working Pressure (kgf/cm ²)	Dimensions(mm)/Length L		
			Grooved Equal Tee	Reducing Tee (XGQT04)					Grooved Equal Tee	Reducing Tee (XGQT04)	
				XGQT03	L1					L2	XGQT03
50x50 2x2	60.3x60.3	21	70	-	-	5x2	141.3x60.3	21	-	122	122
65x50	76.1x60.3	21	-	76	76	125x80	139.7x88.9	21	-	122	122
2.1/2x2	73.0x60.3	21	-	76	76	5x3	141.3x88.9	21	-	122	122
65x65	76.1x76.1	21	76	-	-	125x100	139.7x114.3	21	-	122	122
2.1/2x2.1/2	73.0x73.0	21	76	-	-	5x4	141.3x114.3	21	-	122	122
80x50 3x2	88.9x60.3	21	-	86	86	125x125	139.7x139.7	21	124	-	-
80x65	88.9x76.1	21	-	86	86	5x5	141.3x141.3	21	124	-	-
3x2.1/2	88.9x73.0	21	-	86	86	150x50	165.1x60.3	21	-	140	140
80x80 3x3	88.9x88.9	21	86	-	-	6x2	168.3x60.3	21	-	140	140
100x50 4x2	114.3x60.3	21	-	102	102	150x65	165.1x76.1	21	-	140	140
100x65	114.3x76.1	21	-	102	102	6x2.1/2	168.3x73.0	21	-	140	140
4x2.1/2	114.3x73.0	21	-	102	102	150x80	165.1x88.9	21	-	140	140
100x80 4x3	114.3x88.9	21	-	102	102	6x3	168.3x88.9	21	-	140	140
100x100 4x4	114.3x114.3	21	102	-	-	150x100	165.1x114.3	21	-	140	140
125x50	139.7x60.3	21	-	122	122	6x4	168.3x114.3	21	-	140	140
						150x125	165.1x139.7	21	-	140	140
						6x5	168.3x141.3	21	-	140	140
						150x150	165.1x165.1	21	140	-	-
						6x6	168.3x168.3	21	140	-	-

Ductile Grooved Tee

Threaded Reducing Tee : XGQT04S

Mat'l : Ductile iron(GCD450)

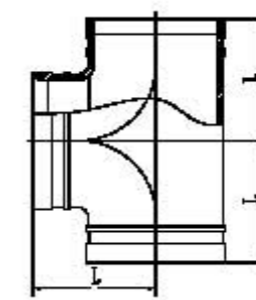

Threaded Reducing Tee

Nominal Size DN inch	Pipe O.D. (mm)	Max. Working Pressure (kgf/cm ²)	Dimensions(mm)/Length L		Nominal Size DN inch	Pipe O.D. (mm)	Max. Working Pressure (kgf/cm ²)	Dimensions(mm)/Length L	
			(XGQT04S)					(XGQT04S)	
			L1	L2				L1	L2
50x25 2x1	60.3x33.7	21	70	70	100x32 4x1.1/4	114.3x42.4	21	102	102
50x32 2x1.1/4	60.3x42.4	21	70	70	100x40 4x1.1/2	114.3x48.3	21	102	102
50x40 2x1.1/2	60.3x48.3	21	70	70	100x50 4x2	114.3x60.3	21	102	102
65x25	76.1x33.7	21	76	76	125x25	139.7x33.7	21	122	122
2.1/2x1	73.0x33.7	21	76	76	5x1	141.3x33.7	21	122	122
65x32	76.1x42.4	21	76	76	125x32	139.7x42.4	21	122	122
2.1/2x1.1/4	73.0x42.4	21	76	76	5x1.1/4	141.3x42.4	21	122	122
65x40	76.1x48.3	21	76	76	125x40	139.7x48.3	21	122	122
2.1/2x1.1/2	73.0x48.3	21	76	76	5x1.1/2	141.3x48.3	21	122	122
65x50	76.1x60.3	21	76	76	125x50	139.7x60.3	21	122	122
2.1/2x2	73.0x60.3	21	76	76	5x2	141.3x60.3	21	122	122
80x25 3x1	88.9x33.7	21	86	86	150x25	165.1x33.7	21	140	140
80x32 3x1.1/4	88.9x42.4	21	86	86	6x1	168.3x33.7	21	140	140
80x40 3x1.1/2	88.9x48.3	21	86	86	150x32	165.1x42.4	21	140	140
80x50 3x2	88.9x60.3	21	86	86	6x1.1/4	168.3x42.4	21	140	140
100x25 4x1	114.3x33.7	21	102	102	150x40	165.1x48.3	21	140	140
					6x1.1/2	168.3x48.3	21	140	140
					150x50	165.1x60.3	21	140	140
					6x2	168.3x60.3	21	140	140

● Ductile Grooved Concentric Reducer

Grooved/ Threaded Outlet : XGQT5/ XGQT5S

▪ Mat'l : Ductile iron(GCD450)



Grooved

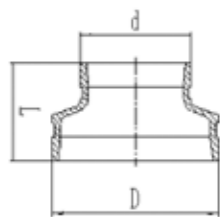

Nominal Size DN inch	Pipe O.D. (mm)	Max.Working Pressure (kgf/cm ²)	Dimensions (mm)/Length L
			Grooved XGQT5
65x50	76,1x60,3	21	64
2,1/2x2	73,0x60,3	21	64
80x50 3x2	88,9x60,3	21	64
80x65	88,9x76,1	21	64
3x2,1/2	88,9x73,0	21	64
100x50 4x2	114,3x60,3	21	76
100x65	114,3x76,1	21	76
4x2,1/2	114,3x73,0	21	76
100x80 4x3	114,3x88,9	21	76
125x65	139,7x76,1	21	89
5x2,1/2	141,3x73,0	21	89
125x80	139,7x88,9	21	89
5x3	141,3x88,9	21	89
125x100	139,7x114,3	21	89
5x4	141,3x114,3	21	89
150x65	165,1x76,1	21	102
6x2,1/2	168,3x73,0	21	102
150x80	165,1x88,9	21	102
6x3	168,3x88,9	21	102
150x100	165,1x114,3	21	102
6x4	168,3x114,3	21	102
150x125	165,1x139,7	21	102
6x5	168,3x141,3	21	102



Threaded

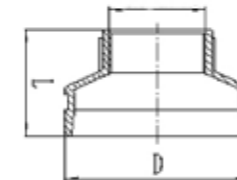

Nominal Size DN inch	Pipe O.D. (mm)	Max.Working Pressure (kgf/cm ²)	Dimensions (mm)/Length L
			Threaded type XGQT5S
50x25 2x1	60,3x33,7	21	64
50x32 2x1,1/4	60,3x42,4	21	64
50x40 2x1,1/2	60,3x48,3	21	64
65x25	76,1x33,7	21	64
2,1/2x1	73,0x33,7	21	64
65x32	76,1x42,4	21	64
2,1/2x1,1/4	73,0x42,4	21	64
65x40	76,1x48,3	21	64
2,1/2x1,1/2	73,0x48,3	21	64
65x50	76,1x60,3	21	64
2,1/2x2	73,0x60,3	21	64
80x25 3x1	88,9x33,7	21	64
80x32 3x1,1/4	88,9x42,4	21	64
80x40 3x1,1/2	88,9x48,3	21	64
80x50 3x2	88,9x60,3	21	64
100x25 4x1	114,3x33,7	21	76
100x32 4x1,1/4	114,3x42,4	21	76
100x40 4x1,1/2	114,3x48,6	21	76
100x50 4x2	114,3x60,3	21	76
125x25	139,7x33,7	21	89
5x1	141,3x33,7	21	89
125x32	139,7x42,4	21	89
5x1,1/4	141,3x42,4	21	89
125x40	139,7x48,3	21	89
5x1,1/2	141,3x48,3	21	89
125x50	139,7x60,3	21	89
5x2	141,3x60,3	21	89
150x25	165,1x33,7	21	102
6x1	168,3x33,7	21	102
150x32	165,1x42,4	21	102
6x1,1/4	168,3x42,4	21	102
150x40	165,1x48,3	21	102
6x1,1/2	168,3x48,3	21	102
150x50	165,1x60,3	21	102
6x2	168,3x60,3	21	102

Grooved Joint
Ductile Grooved Fittings
Carbon Grooved Fittings
STS Grooved Fittings
New method for grooved joint system
Grooved machine and spare parts
Technical Information
Piping manual
Material Approval Sheets

● Ductile Grooved Eccentric Reducer XGQT05

Grooved Equal/Reducing Cross : XGQT05

▪ Mat'l : Ductile iron(GCD450)

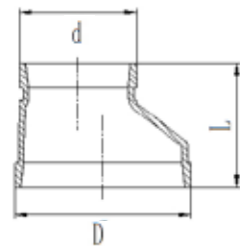

Nominal Size DN inch	Pipe O.D. (mm)	Max.Working Pressure (kgf/cm ²)	Dimensions (mm)/Length L	
			Grooved	
			XGQT05	
80x50 3x2	88,9x60,3	21	64	
100x65	114,3x76,1	21	76	
4x2,1/2	114,3x73,0	21	76	
100x80 4x3	114,3x88,9	21	76	
125x100	139,7x114,3	21	89	
5x4	141,3x114,3	21	89	
150x65	165,1x76,1	21	102	
6x2,1/2	168,3x73,0	21	102	
150x80	165,1x88,9	21	102	
6x3	168,3x88,9	21	102	
150x100	165,1x114,3	21	102	
6x4	168,3x114,3	21	102	
150x125	165,1x139,7	21	102	
6x5	168,3x141,3	21	102	

● Ductile Grooved Flange Adaptor

Grooved Outlet : XGQT08

▪ Mat'l : Ductile iron(GCD450)

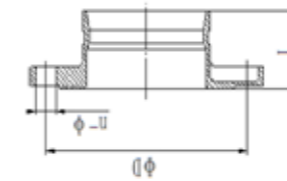
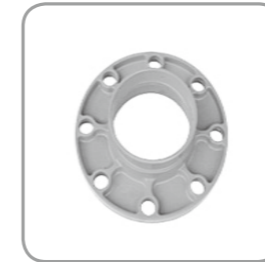

Nominal Size DN inch	Pipe O.D. (mm)	Dimensions (mm) /Length L	10K (810K)	
			(D)	Bolts
50 2	60,3	65	120	4-5/8
65	76,1	65	140	4-5/8
2,1/2	73,0	65	140	4-5/8
80 3	88,9	65	150	8-5/8
100 4	114,3	70	175	8-5/8
125	139,7	70	210	8-5/8
5	141,3	70	210	8-5/8
150	165,1	70	240	8-3/4
6	168,3	70	240	8-3/4
200	216,3	80	290	12-7/8
8	219,1	80	290	8-3/4

● Ductile Grooved Cap

Grooved Outlet : XGQT06

▪ Mat'l : Ductile iron(GCD450)

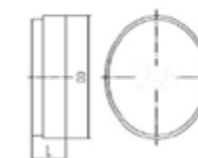

Nominal Size DN inch	Pipe O.D. (mm)	Max.Working Pressure (kgf/cm ²)	Dimensions (mm)/Length L
50 2	60,3	21	24
65	76,1	21	24
2,1/2	73,0	21	24
80 3	88,9	21	24
100 4	114,3	21	26
125	139,7	21	26
5	141,3	21	26
150	165,1	21	26
6	168,3	21	26
200	216,3	21	28
8	219,1	21	28