

NEWASIA
ASIAJOINT

Grooved Joint

Catalog



NEWASIA
ASIAJOINT

<http://www.ajs.co.kr>

One-Stop Grooved Joint

Rigid : AJ550R

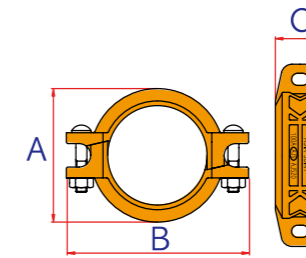

- Joint mat'l : Ductile iron(GCD450)
- Gasket mat'l : EPDM
- Bolt/Nut mat'l : CS for machine structural use
- Paint : Epoxy coat

Nominal Size (DN)	Pipe O.D. (mm)	Max. Working Pressure (kgf/cm ²)	Max. End Load (kN)	Allow. Pipe End Sep (mm)	Dimensions(mm)			Bolt Size (Φ X L)	Wrench Size (mm)	Weight (kg)
					A	B	C			
50	60.5	30	6.9	1.6	87	134	47	M10 X 60	17	0.96
65	76.3	30	11.0	1.6	103	151	47	M10 X 65	17	1.09
80	89.1	30	15.0	1.6	117	165	47	M10 X 65	17	1.37
100	114.3	30	24.6	2.9	143	198	50	M12 X 65	19	1.74
125	139.8	30	32.2	2.9	169	225	50	M12 X 75	19	2.16
150	165.2	26	45.0	2.9	200	260	50	M12 X 80	19	2.41
200	216.3	26	77.2	3.2	255	330	62	M16 X 85	24	4.15

Flexible : AJ550F

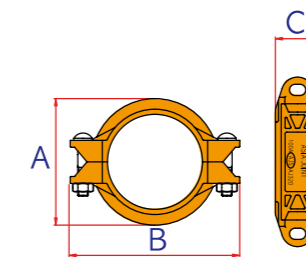

- Joint mat'l : Ductile iron(GCD450)
- Gasket mat'l : EPDM
- Bolt/Nut mat'l : CS for machine structural use
- Paint : Epoxy coat

Nominal Size (DN)	Pipe O.D. (mm)	Max. Working Pressure (kgf/cm ²)	Max. End Load (kN)	Allow. Pipe End Sep (mm)	Degrees-per Joint	Pipe Deflection (mm/6m)	Dimensions(mm)			Bolt Size (Φ X L)	Wrench Size (mm)	Weight (kg)
							A	B	C			
50	60.5	30	6.9	1.6	1.51 °	158.2	87	134	47	M10 X 60	17	0.96
65	76.3	30	11.0	1.6	1.20 °	125.7	103	151	47	M10 X 65	17	0.92
80	89.1	30	15.0	1.6	1.03 °	107.9	117	165	47	M10 X 65	17	1.37
100	114.3	30	24.6	3.2	1.60 °	167.6	143	198	50	M12 X 65	19	1.74
125	139.8	30	32.2	3.2	1.31 °	137.2	169	225	50	M12 X 75	19	2.11
150	165.2	26	45.0	3.2	1.11 °	116.3	200	260	50	M12 X 80	19	2.32
200	216.3	26	77.2	3.2	1.83 °	191.7	255	330	62	M16 X 85	24	4.14

Grooved Joint

One-Stop Grooved Joint

Rigid : AJ560R

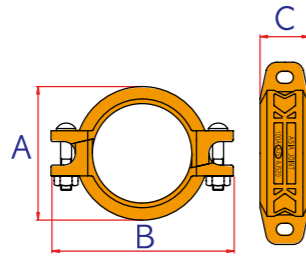

- Joint mat'l : Ductile iron(A536)
- Gasket mat'l : EPDM
- Bolt/Nut mat'l : CS for machine structural use
- Paint : Epoxy coat

Nominal Size (Inch)	Pipe O.D. (mm)	Max.Working Pressure (kgf/cm ²)	Max.End Load (kN)	Allow.Pipe End Sep (mm)	Dimensions(mm)			Bolt Size (Φ X L)	Wrench Size (mm)	Weight (kg)
					A	B	C			
2	60.3	30	6.9	1.6	87	134	47	M10 X 60	17	0.96
2.1/2	73.0	30	11.0	1.6	96	140	45	M10 X 65	17	0.89
3	88.9	30	15.0	1.6	117	165	47	M10 X 65	17	1.37
4	114.3	30	24.6	2.9	143	198	50	M12 X 65	19	1.74
5	141.3	30	32.2	2.9	170	227	50	M12 X 75	19	2.03
6	168.3	26	45.0	2.9	196	250	50	M12 X 80	19	2.24
8	219.1	26	77.2	3.2	255	327	60	M16 X 90	24	4.04

Flexible : AJ560F

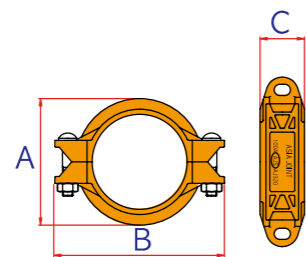

- Joint mat'l : Ductile iron(A536)
- Gasket mat'l : EPDM
- Bolt/Nut mat'l : CS for machine structural use
- Paint : Epoxy coat

Nominal Size (Inch)	Pipe O.D. (mm)	Max.Working Pressure (kgf/cm ²)	Max.End Load (kN)	Allow. Pipe End Sep (mm)	De-grees-per Joint	Pipe Deflection (mm/6m)	Dimensions(mm)			Bolt Size (Φ X L)	Wrench Size (mm)	Weight (kg)
							A	B	C			
2	60.3	30	6.9	1.6	1.51°	158.2	87	134	47	M10 X 60	17	0.94
2.1/2	73.0	30	11.0	1.6	1.20°	125.7	96	140	45	M10 X 65	17	0.92
3	88.9	30	15.0	1.6	1.03°	107.9	117	165	47	M10 X 65	17	1.37
4	114.3	30	24.6	3.2	1.60°	167.6	143	198	50	M12 X 65	19	1.77
5	141.3	30	32.2	3.2	1.31°	137.2	170	227	50	M12 X 75	19	2.11
6	168.3	26	45.0	3.2	1.11°	116.3	196	250	50	M12 X 80	19	2.32
8	219.1	26	77.2	3.2	1.83°	191.7	255	327	60	M16 X 90	24	4.14

Grooved Joint

Rigid : AJS510R

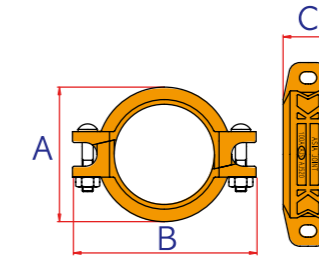

- Joint mat'l : Ductile iron(GCD450)
- Gasket mat'l : EPDM
- Bolt/Nut mat'l : CS for machine structural use
- Paint : Epoxy coat

Nominal Size DN inch	Pipe O.D. (mm)	Max.Working Pressure (kgf/cm ²)	Max.End Load (kN)	Allow.Pipe End Sep (mm)	Dimensions(mm)			Bolt Size (Φ X L)	Wrench Size (mm)	Weight (kg)
					A	B	C			
25	33.7	21	2.1	1.2	58	97	45.5	M10 X 45	17	0.6
32	42.4	21	3.4	1.2	66	108	45.5	M10 X 55	17	0.64
40	48.3	21	4.4	1.2	74	114	45.5	M10 X 55	17	0.66
50	60.3	21	6.9	1.6	85	128	45.5	M10 X 55	17	0.72
65	76.1	21	11.0	1.6	98	144	45.5	M10 X 55	17	0.86
2.1/2	73	21	11.0	1.6	98	144	45.5	M10 X 55	17	0.86
80	88.9	21	15.0	1.6	112	164	46	M12 X 65	17	1.08
100	114.3	21	24.6	2.9	138	192	50	M12 X 65	19	1.26
125	139.7	21	32.2	2.9	168	223	50	M12 X 75	19	1.86
5	141.3	21	32.2	2.9	168	223	50	M12 X 75	19	1.86
150	165.1	21	45.0	2.9	194	247	50	M12 X 75	19	2.20
6	168.3	21	45.0	2.9	194	247	50	M12 X 75	19	2.20
200	216.3	21	77.2	3.2	256	320	60	M16 X 90	24	4.40
8	219.1	21	77.2	3.2	256	320	60	M16 X 90	24	4.40
250	267.4	21	110.0	4.5	316	408	65	M20 X 120	30	6.50
10	273.0	21	110.0	4.5	316	408	65	M20 X 120	30	6.50
300	318.5	21	156.0	4.5	372	460	65	M22 X 140	30	8.00
12	323.9	21	156.0	4.5	372	460	65	M22 X 140	30	8.00

Flexible : AJS510F

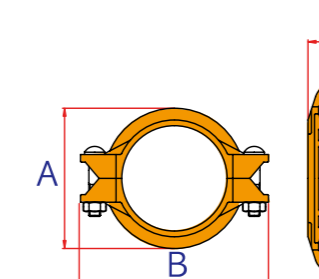

- Joint mat'l : Ductile iron(GCD450)
- Gasket mat'l : EPDM
- Bolt/Nut mat'l : CS for machine structural use
- Paint : Epoxy coat

Nominal Size DN inch	Pipe O.D. (mm)	Max.Working Pressure (kgf/cm ²)	Max.End Load (kN)	Allow.Pipe End Sep (mm)	Degrees-per Joint	Pipe Deflection (mm/6m)	Dimensions(mm)			Bolt Size (Φ X L)	Wrench Size (mm)	Weight (kg)
							A	B	C			
50	60.3	21	6.9	1.6	1.51°	158.2	85	128	45.5	M10 X 55	17	0.70
65	76.1	21	11.0	1.6	1.20°	125.7	98	144	45.5	M10 X 55	17	0.78
2.1/2	73.0	21	11.0	1.6	1.20°	125.7	98	144	45.5	M10 X 55	17	0.78
80	88.9	21	15.0	1.6	1.03°	107.9	112	164	46	M12 X 65	17	0.92
100	114.3	21	24.6	3.2	1.60°	167.6	138	192	50	M12 X 65	19	1.42
125	139.7	21	32.2	3.2	1.31°	137.2	168	223	50	M12 X 75	19	1.84
5	141.3	21	32.2	3.2	1.31°	137.2	168	223	50	M12 X 75	19	1.84
150	165.1	21	45.0	3.2	1.11°	116.3	194	247	50	M12 X 75	19	2.22
6	168.3	21	45.0	3.2	1.11°	116.3	194	247	50	M12 X 75	19	2.22
200	216.3	21	77.2	3.2	1.83°	191.7	256	320	60	M16 X 90	24	4.02
8	219.1	21	77.2	3.2	1.83°	191.7	256	320	60	M16 X 90	24	4.02

Grooved Joint for High pressure and STS

Rigid : AJ520

- Joint mat'l : Ductile iron(GCD450)
- Gasket mat'l : EPDM
- Bolt/Nut mat'l : CS for machine structural use
- Paint : Epoxy coat

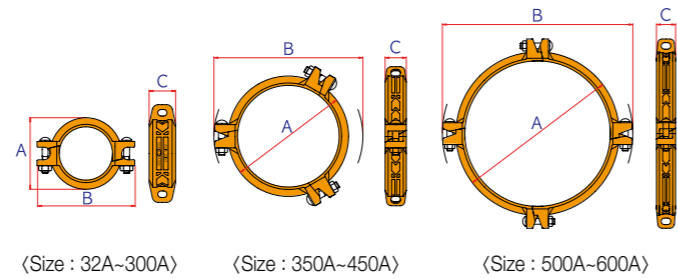
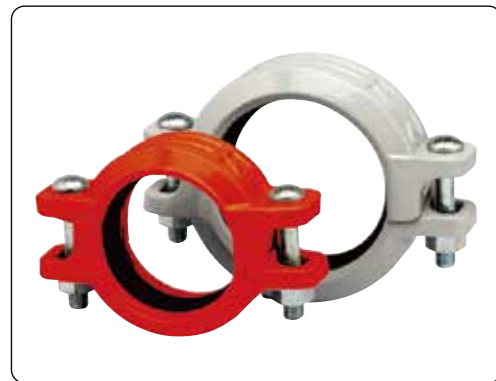

Nominal Size DN Inch	Pipe O.D. (mm)	Max.Working Pressure (kgf/cm ²)	Max.End Load (kN)	Allow.Pipe End Sep (mm)	Dimensions(mm)			Bolt Size (Φ X L)	Wrench Size (mm)	Weight (kg)
					A	B	C			
25 1	33.7	52	4.6	1.1	60	101	47	M10 X 50	17	0.64
32 1,1/4	42.4	52	7.3	1.1	68	105	47	M10 X 60	17	0.72
40 1,1/2	48.3	52	9.7	1.1	76	113	48	M10 X 60	17	0.88
50 2	60.3	52	15.0	1.6	87	123	50	M10 X 70	17	1.06
65 2,1/2	76.1	52	23.8	1.6	103	142	51	M10 X 70	17	1.30
80 3	88.9	52	32.4	1.6	116	170	51	M12 X 75	19	1.68
100 4	114.3	52	53.4	2.9	148	202	55	M12 X 75	19	2.16
125 5	139.7	48	73.6	2.9	174	242	55	M16 X 95	24	3.00
150 6	165.1	48	102.9	2.9	200	269	56	M16 X 95	24	3.50
200	216.3	41	150.7	3.2	261	341	65	M20 X 120	30	6.80

※ Contact us for 32A

Grooved Joint for High pressure and STS

Rigid : AJ520

- Joint mat'l : Ductile iron(A536)
- Gasket mat'l : EPDM
- Bolt/Nut mat'l : CS for machine structural use
- Paint : Epoxy coat

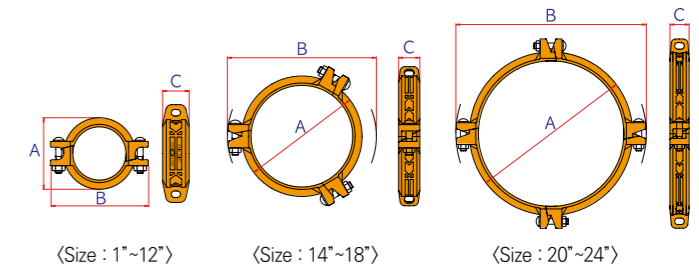

Nominal Size DN Inch	Pipe O.D. (mm)	Max.Working Pressure (kgf/cm ²)	Max.End Load (kN)	Allow.Pipe End Sep (mm)	Dimensions(mm)			Bolt Size (Φ X L)	Wrench Size (mm)	Weight (kg)
					A	B	C			
8	219.1	41	150.7	3.2	261	341	65	M20 X 120	30	6.80
250	267.4	34	190.9	3.2	315	399	66	M20 X 120	30	8.82
10	273.0	34	190.9	3.2	315	399	66	M20 X 120	30	8.82
300	318.5	27	215.1	3.2	370	468	67	M22 X 155	32	12.68
12	323.9	27	215.1	3.2	370	468	67	M22 X 155	32	12.68
350 14	355.6	17	168.8	3.2	413	513	73	M22 X 115	32	16.64
400 16	406.4	17	220.5	3.2	465	563	73	M22 X 115	32	18.66
450 18	457.2	17	279.1	2.6	519	616	76	M22 X 115	32	19.28
500 20	508.0	17	344.6	3.3	573	686	78	M24 X 120	32	26.82
600 24	610.0	17	496.2	3.3	673	787	79	M24 X 120	32	32.04

Grooved Joint for High pressure and STS

Flexible : AJ320

- Joint mat'l : Ductile iron(GCD450)
- Gasket mat'l : EPDM
- Bolt/Nut mat'l : CS for machine structural use
- Paint : Epoxy coat

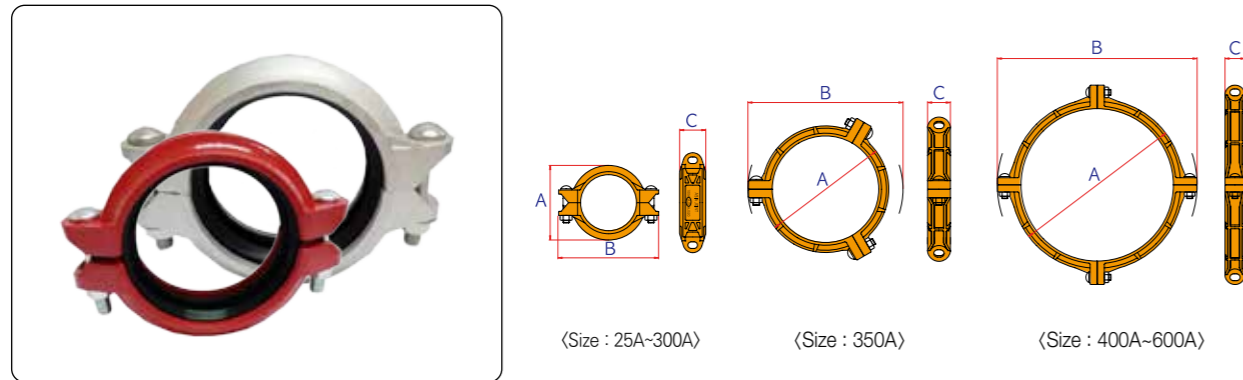

Nominal Size DN Inch	Pipe O.D. (mm)	Max.Working Pressure (kgf/cm ²)	Max.End Load (kN)	Allow. Pipe End Sep (mm)	Degrees-per Joint	Pipe Deflection (mm/6m)	Dimensions(mm)			Bolt Size (Φ X L)"	Wrench Size (mm)	Weight (kg)
							A	B	C			
25 1	33,7	40	3,6	1,3	2,19 °	229,33	60	101,4	46,2	M10 X 50	17	0,60
32 1,1/4	42,4	40	5,7	1,6	2,16 °	226,30	69	103	46	M10 X 60	17	0,66
40 1,1/2	48,3	40	7,4	1,6	1,90 °	199,04	75	108	46	M10 X 60	17	0,70
50 2	60,3	40	11,5	1,6	1,51 °	158,16	87	129	47	M10 X 60	17	0,80
65	76,1	40	18,3	1,6	1,20 °	125,68	105	147	47	M10 X 60	17	0,90
2,1/2	73,0	40	18,3	1,6	1,20 °	125,68	105	147	47	M10 X 60	17	0,90
80 3	88,9	40	24,9	1,6	1,03 °	107,87	118	164	47	M12 X 75	19	1,38
100 4	114,3	40	41,0	3,2	1,60 °	167,60	149	197	51	M12 X 75	19	2,02
125	139,7	36	55,2	3,2	1,31 °	137,21	176	248	52	M16 X 95	24	2,92
5	141,3	36	55,2	3,2	1,31 °	137,21	176	248	52	M16 X 95	24	2,92
150	165,1	36	77,2	3,2	1,11 °	116,25	200	265	52	M16 X 95	24	3,02
6	168,3	36	77,2	3,2	1,11 °	116,25	200	265	52	M16 X 95	24	3,02

Grooved Joint for High pressure and STS

Flexible : AJ320

- Joint mat'l : Ductile iron(A536)
- Gasket mat'l : EPDM
- Bolt/Nut mat'l : CS for machine structural use
- Paint : Epoxy coat

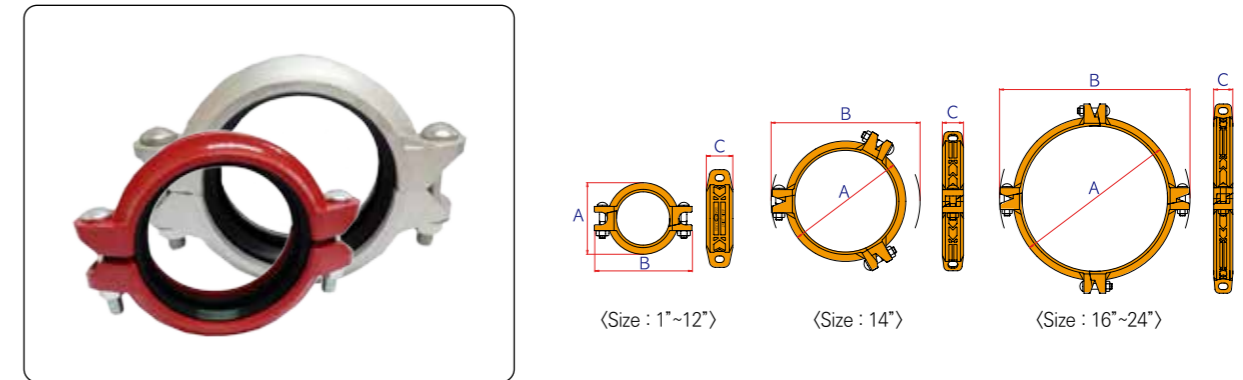

Nominal Size DN Inch	Pipe O.D. (mm)	Max.Working Pressure (kgf/cm ²)	Max.End Load (kN)	Allow. Pipe End Sep (mm)	Degrees-per Joint	Pipe Deflection (mm/6m)	Dimensions(mm)			Bolt Size (Φ X L)"	Wrench Size (mm)	Weight (kg)
							A	B	C			
200	216,3	30	110,2	3,2	1,83 °	191,70	260	350	61	M20 X 120	30	5,90
8	219,1	30	110,2	3,2	1,83 °	191,70	260	350	61	M20 X 120	30	5,90
250	267,4	30	168,5	3,2	1,33 °	139,30	312	402	66	M20 X 165	30	11,80
10	273,0	30	168,5	3,2	1,33 °	139,30	312	402	66	M20 X 165	30	11,80
300	318,5	30	239,0	3,2	1,13 °	118,35	363	460	66	M22 X 155	32	14,50
12	323,9	30	239,0	3,2	1,13 °	118,35	363	460	66	M22 X 155	32	14,50
350 14	355,6	25	248,3	3,2	1,03 °	107,87	416	507	75	M22 X 90	32	15,24
400 16	406,4	25	324,3	3,2	0,90 °	94,26	468	561	76	M24 X 90	32	19,18
450 18	457,2	25	410,4	3,2	0,80 °	83,78	520	614	78	M24 X 90	32	21,40
500 20	508,0	20	405,4	3,2	0,71 °	74,35	574	684	78	M24 X 90	32	25,02
600 24	610,0	20	583,7	3,2	0,60 °	62,83	677	786	79	M24 X 90	32	30,14

Stainless Steel Grooved Joint

Flexible : AJ130F

- Joint mat'l : STS casting (SCS-13, CF8)
- Gasket mat'l : EPDM
- Bolt/Nut mat'l : STS steel

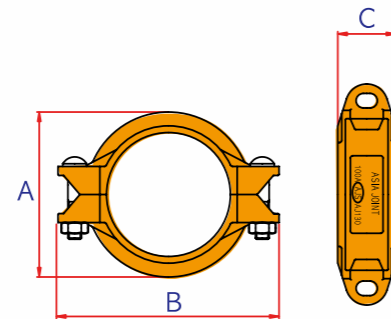

Nominal Size DN Inch	Pipe O.D. (mm)	Max.Working Pressure (kgf/cm ²)	Max.End Load (kN)	Allow. Pipe End Sep (mm)	De-grees-per Joint	Pipe Deflection (mm/6m)	Dimensions(mm)			Bolt Size (Φ X L)	Wrench Size (mm)	Weight (kg)
							A	B	C			
25 1	34.0	32	2.9	1.3	2.19 °	229.33	57	96	44	M10 X 50	17	0.51
32 1.1/4	42.7	32	4.6	1.6	2.16 °	226.30	65	106	44	M10 X 50	17	0.58
40 1.1/2	48.6	32	5.9	1.6	1.90 °	199.04	71	111	44	M10 X 50	17	0.66
50 2	60.5	32	9.2	1.6	1.51 °	158.16	84	129	45	M10 X 50	17	0.82
65 2.1/2	76.3	32	14.6	1.6	1.20 °	125.68	100	147	46	M10 X 55	17	1.04
80 3	89.1	32	20.0	1.6	1.03 °	107.87	112	165	47	M12 X 75	19	1.24
100 4	114.3	32	32.8	3.2	1.60 °	167.60	142	198	51	M12 X 75	19	1.78
125 5	139.8	24	36.8	3.2	1.31 °	137.21	171	234	51	M16 X 75	24	2.40
150 6	165.2	24	51.4	3.2	1.11 °	116.25	202	270	51	M16 X 90	24	4.51
200 8	216.3	24	88.2	3.2	1.83 °	191.70	261	350	61	M24 X 140	32	8.24
250 10	267.4	21	112.3	3.2	1.33 °	139.30	315	400	65	M24 X 140	32	8.48
300 12	318.5	21	159.4	3.2	1.13 °	118.35	370	461	65	M24 X 170	32	12.22
323.9	323.9	21	159.4	3.2	1.13 °	118.35	375	466	65	M24 X 170	32	12.22

Stainless Steel Grooved Joint

Rigid : AJ130R

- Joint mat'l : STS casting (SCS-13, CF8)
- Gasket mat'l : EPDM
- Bolt/Nut mat'l : STS steel

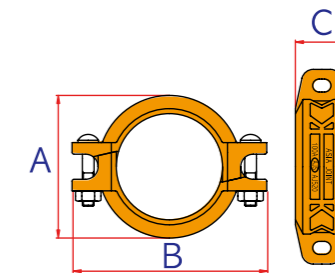

Nominal Size DN Inch	Pipe O.D. (mm)	Max.Working Pressure (kgf/cm ²)	Max.End Load (kN)	Allow. Pipe End Sep (mm)	Dimensions(mm)			Bolt Size (Φ X L)	Wrench Size (mm)	Weight (kg)
					A	B	C			
25 1	34.0	32	2.9	1.3	57	96	44	M10 X 50	17	0.51
32 1.1/4	42.7	32	4.6	1.6	65	106	44	M10 X 50	17	0.58
40 1.1/2	48.6	32	5.9	1.6	71	111	44	M10 X 50	17	0.66
50 2	60.5	32	9.2	1.6	84	129	45	M10 X 50	17	0.82
65 2.1/2	76.3	32	14.6	1.6	100	147	46	M10 X 55	17	1.04
80 3	89.1	32	20.0	1.6	112	165	47	M12 X 75	19	1.24
100 4	114.3	32	32.8	3.2	142	198	51	M12 X 75	19	1.78
125 5	139.8	24	36.8	3.2	171	234	51	M16 X 75	24	2.40
150 6	165.2	24	51.4	3.2	202	270	51	M16 X 90	24	4.51
200 8	216.3	24	88.2	3.2	261	350	61	M24 X 140	32	8.24
250 10	267.4	21	112.3	3.2	315	400	65	M24 X 140	32	8.48
300 12	318.5	21	159.4	3.2	370	461	65	M24 X 170	32	12.22
323.9	323.9	21	159.4	3.2	375	466	65	M24 X 170	32	12.22

Reducing Joint : XGQT1B

- Joint mat'l : Dductile iron (GCD450)
- Gasket mat'l : EPDM
- Bolt/Nut mat'l : CS for machine structural use
- Paint : Epoxy coat

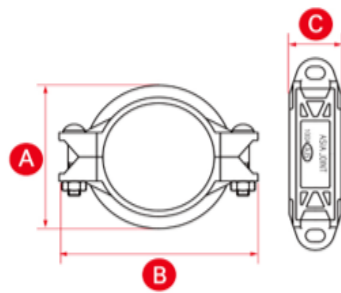

Nominal Size DN inch	Pipe O.D mm	Max. Working Pressure kgf/cm2	Dimensions mm			Bolt/Nut	Wrench Size mm
			A	B	C		
65x50	76.1x60.3	21	102	143	45	M10x65	17
2.1/2x2	73.0x60.3	21	102	143	45	M10x65	17
80x50 3x2	88.9x60.3	21	118	163	47	M12x70	19
80x65 3x2.1/2	88.9x73.0	21	118	163	47	M12x70	19
100x50 4x2	114.3x60.3	21	149	200	50	M12x70	19
100x65	114.3x76.1	21	149	200	50	M12x70	19
4x2.1/2	114.3x73.0	21	149	200	50	M12x70	19
100x80 4x3	114.3x88.9	21	149	200	50	M12x70	19
6x3	168.3x88.9	21	200	270	53	M16x85	24
150x100	165.1x114.3	21	200	270	53	M16x85	24
6x4	168.3x114.3	21	200	270	53	M16x85	24
8x6	219.1x168.3	21	260	335	62	M20x110	30

※ Contact us special size

One-Stop Reducing Joint : AJ730RC

- Joint mat'l : Ductile iron (GCD450)
- Gasket mat'l : EPDM
- Bolt/Nut mat'l : CS for machine structural use
- Paint : Epoxy coat

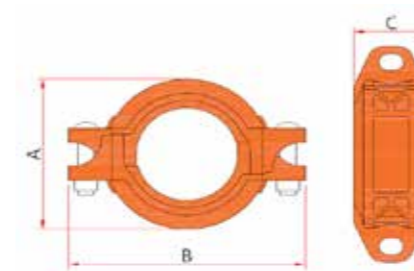

Size DN Inch	Pipe O.D. (mm)	Max. Working Pressure (kgf/cm2)	Dimensions(mm)			Bolt Size (Φ X L)	Wrench Size (mm)
			A	B	C		
32x25 1.1/4x1	42.7x34.0	21	66	104.5	46	M10 X 55	17
40x32 1.1/2x1.1/4	48.6x42.7	21	71	111.6	46	M10 X 55	17
50x40 2x1.1/2	60.5x48.6	21	87	125	46	M10 X 55	17
65x50	76.3x60.5	21	101	145.2	46	M10 X 65	17
2.1/2x2	73.0x60.3	21	98	145.2	46	M10 X 65	17

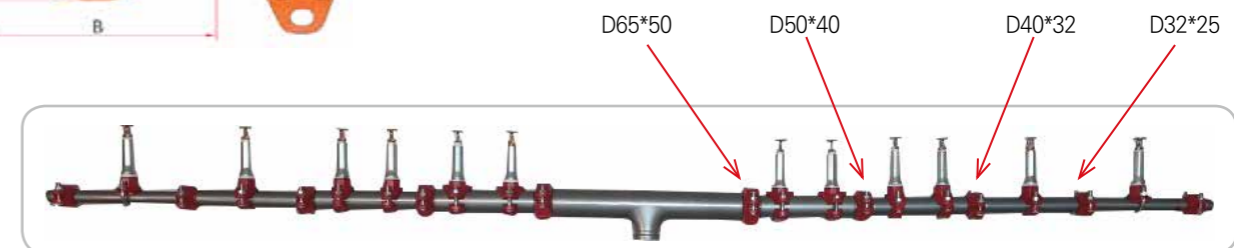

Assembled products



Grooved Long Tee

- Size : 50A ~ 65A
- Mat'l : SPP, S40/spps250
- Paint : Epoxy coat



Onestop Reducing Grooved Joint

- Size : 65x50,50x40,40x32,32x25
- Mat'l : Ductile iron (GCD450)
- Bolt/Nut mat'l : CS for machine structural use
- Paint : Epoxy coat



Equal Mechanical tee

- Size : 25A~50A
- Mat'l : Ductile iron (GCD450)
- Bolt/Nut mat'l : CS for machine structural use
- Paint : Epoxy coat

Mechanical Tee Joint

Threaded Outlet : AJS710T

- Joint mat'l : Ductile iron (GCD450)
- Gasket mat'l : EPDM
- Bolt/Nut mat'l : CS for machine structural use
- Paint : Epoxy coat

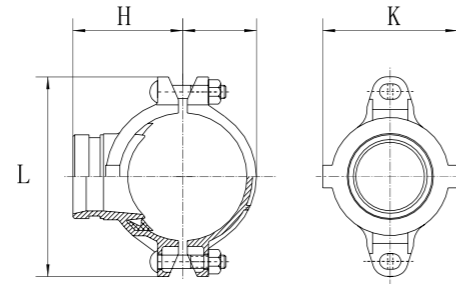

Nominal Size (A)	Pipe O.D. (mm)	Max. Working Pressure (kgf/cm ²)	Dimensions(mm)			Bolt Size (Φ X L)	Wrench Size (mm)	Hole Dia
			L	K	H			
25x25	34.0x34.0	21	90	56	49	M10x50	15	27
50x25	60.5x34.0	21	116	58	72	M10x55	15	38
65x25	76.3x34.0	21	128	68	83	M10x60	15	38
65x32	76.3x42.7	21	128	76	83	M10x60	15	51
65x40	76.3x48.6	21	128	76	83	M10x60	15	51
80x25	89.1x34.0	21	151	78	74	M12x65	19	38
80x32	89.1x42.7	21	151	78	86	M12x65	19	51
80x40	89.1x48.6	21	151	78	86	M12x65	19	51
80x50	89.1x60.5	21	151	78	101	M12x65	19	64
100x25	114.3x34.0	21	183	88	76	M12x75	19	38
100x32	114.3x42.7	21	183	94	89	M12x75	19	51
100x40	114.3x48.6	21	183	94	89	M12x75	19	51
100x50	114.3x60.5	21	183	98	105	M12x75	19	64
100x65	114.3x76.3	21	183	100	110	M12x75	19	70
125x25	139.8x34.0	21	219	103	80	M16x80	24	38
125x32	139.8x42.7	21	219	103	93	M16x80	24	51
125x40	139.8x48.6	21	219	103	93	M16x80	24	51
125x50	139.8x60.5	21	219	107	105	M16x80	24	64
150x25	165.2x34.0	21	250	115	75	M16x90	24	38
150x32	165.2x42.7	21	250	115	93	M16x90	24	51
150x40	165.2x48.6	21	250	115	93	M16x90	24	51
150x50	165.2x60.5	21	250	115	107	M16x90	24	64
150x65	165.2x76.3	21	250	125	115	M16x90	24	70

※ D25*25 : AJ710T ※ Contact us special size

Nominal Size (inch)	Pipe O.D. (mm)	Max. Working Pressure (kgf/cm ²)	Dimensions(mm)			Bolt Size (Φ X L)	Wrench Size (mm)	Hole Dia
			L	K	H			
1x1	33.4x33.4	21	90	56	49	M10x50	15	27
2x1	60.3x33.4	21	116	58	72	M10x55	15	38
2.1/2x1	73.0x33.4	21	128	68	83	M10x60	15	38
2.1/2x1.1/4	73.0x42.2	21	128	76	83	M10x60	15	51
2.1/2x1.1/2	73.0x48.3	21	128	76	83	M10x60	15	51
3x1	88.9x33.4	21	151	78	74	M12x65	19	38
3x1.1/4	88.9x42.2	21	151	78	86	M12x65	19	51
3x1.1/2	88.9x48.3	21	151	78	86	M12x65	19	51
3x2	88.9x60.3	21	151	78	101	M12x65	19	64
4x1	114.3x33.4	21	183	88	76	M12x75	19	38
4x1.1/4	114.3x42.2	21	183	94	89	M12x75	19	51
4x1.1/2	114.3x48.3	21	183	94	89	M12x75	19	51
4x2	114.3x60.3	21	183	98	105	M12x75	19	64
4x2.1/2	114.3x73.0	21	183	100	110	M12x75	19	70
5x1	141.3x33.4	21	219	103	80	M16x80	24	38
5x1.1/4	141.3x42.2	21	219	103	93	M16x80	24	51
5x1.1/2	141.3x48.3	21	219	103	93	M16x80	24	51
5x2	141.3x60.3	21	219	107	105	M16x80	24	64
6x1	168.3x33.4	21	250	115	75	M16x90	24	38
6x1.1/4	168.3x42.2	21	250	115	93	M16x90	24	51
6x1.1/2	168.3x48.3	21	250	115	93	M16x90	24	51
6x2	168.3x60.3	21	250	115	107	M16x90	24	64
6x2.1/2	168.3x73.0	21	250	125	115	M16x90	24	70

Mechanical Tee Joint

Grooved Outlet : AJS720G

- Joint mat'l : Ductile iron (GCD450)
- Gasket mat'l : EPDM
- Bolt/Nut mat'l : CS for machine structural use
- Paint : Epoxy coat

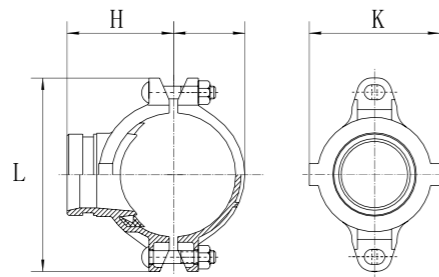

Nominal Size (A)	Pipe O.D. (mm)	Max. Working Pressure (kgf/cm ²)	Dimensions(mm)			Bolt Size (Φ X L)	Wrench Size (mm)	Hole Dia
			L	K	H			
50x32	60.5x42.7	21	116	66	75	M10x55	15	51
50x40	60.5x48.6	21	116	66	75	M10x55	15	51
65x32	76.3x42.7	21	128	78	84	M10x60	15	51
65x40	76.3x48.6	21	128	78	84	M10x60	15	51
80x32	89.1x42.7	21	151	80	86	M12x65	19	51
80x40	89.1x48.6	21	151	80	86	M12x65	19	51
80x50	89.1x60.5	21	151	80	101	M12x65	19	64
100x40	114.3x48.6	21	183	100	88	M12x75	19	51
100x50	114.3x60.5	21	183	100	105	M12x75	19	64
100x65	114.3x76.3	21	183	100	110	M12x75	19	70
125x40	139.8x48.6	21	219	110	92	M16x80	24	51
125x50	139.8x60.5	21	219	110	105	M16x80	24	64
125x65	139.8x76.3	21	219	110	110	M16x80	24	70
125x80	139.8x89.1	21	219	110	124	M16x80	24	89
150x50	165.2x60.5	21	250	127	105	M16x90	24	64
150x65	165.2x76.3	21	250	127	110	M16x90	24	70
150x80	165.2x89.1	21	250	127	130	M16x90	24	89
150x100	165.2x114.3	21	250	127	159	M16x90	24	114

※ Contact us special size

Nominal Size (inch)	Pipe O.D. (mm)	Max. Working Pressure (kgf/cm ²)	Dimensions(mm)			Bolt Size (Φ X L)	Wrench Size (mm)	Hole Dia
			L	K	H			
2x1.1/4	60.3x42.2	21	116	66	75	M10x55	15	51
2x1.1/2	60.3x48.3	21	116	66	75	M10x55	15	51
2.1/2x1.1/4	73.0x42.2	21	128	78	84	M10x60	15	51
2.1/2x1.1/2	73.0x48.3	21	128	78	84	M10x60	15	51
3x1.1/4	88.9x42.2	21	151	80	86	M12x65	19	51
3x1.1/2	88.9x48.3	21	151	80	86	M12x65	19	51
3x2	88.9x60.3	21	151	80	101	M12x65	19	64
4x1.1/2	114.3x48.3	21	183	100	88	M12x75	19	51
4x2	114.3x60.3	21	183	100	105	M12x75	19	64
4x2.1/2	114.3x73.0	21	183	100	110	M12x75	19	70
5x1.1/2	141.3x48.3	21	219	110	92	M16x80	24	51
5x2	141.3x60.3	21	219	110	105	M16x80	24	64
5x2.1/2	141.3x73.0	21	219	110	110	M16x80	24	70
5x3	141.3x88.9	21	219	110	124	M16x80	24	89
6x2	168.3x60.3	21	250	127	105	M16x90	24	64
6x2.1/2	168.3x73.0	21	250	127	110	M16x90	24	70
6x3	168.3x88.9	21	250	127	130	M16x90	24	89
6x4	168.3x114.3	21	250	127	159	M16x90	24	114